



TM

VITAL

Electrocomp



Google Us : Vital Connectors

Manufacturer of PCB Terminal Blocks, Fuse Holders, Barrier Terminals, & Switches

DPDT ON/ON

Picture shows
Screw Type,
Lug Type
is also Available



TECHNICAL SPECIFICATIONS :

HV Breakdown Test	: 2 kV ac for 1 minute
Contact Rating	: 6 Amp, 10 Amp, 16 Amp
Contact Resistance	: <20 mΩ
Insulation Resistance	: > 1 G Ω
Contact Arrangement	: DPDT ON/ON
Operating Force	: 930 to 970 gms
Mechanical Life (No. of cycles)	: 50,000 Operations
Electrical Life (No. of cycles)	: 10,000 Operations
Ambient Temperature	: -25 C to +85 C
Mounting Arrangement	: Panel Mounting, Chassis Mounting
Housing Color Available	: 6 Amp (black), 10 Amp (white), 16 Amp (blue)
Housing Material	: PBT GF or Polyamide 66
Actuator/Handle	: Brass Nickel Plated
Hardware (Bush set)	: Brass Nickel Plated
Electrical Contacts	: Electrolytic Copper/Bi-metallic Silver
Button	: High temperature Thermoplastic
Spring	: Stainless Steel or Spring Steel
Housing Bracket	: MS Zinc plated / SS
Reference Standard	: JSS 50201
Connection Type	: Screw Type or Lug Type
Usage	: Control Panels, Machines, Stabilizers, UPS, Inverter

Heavy Duty Toggle Switches

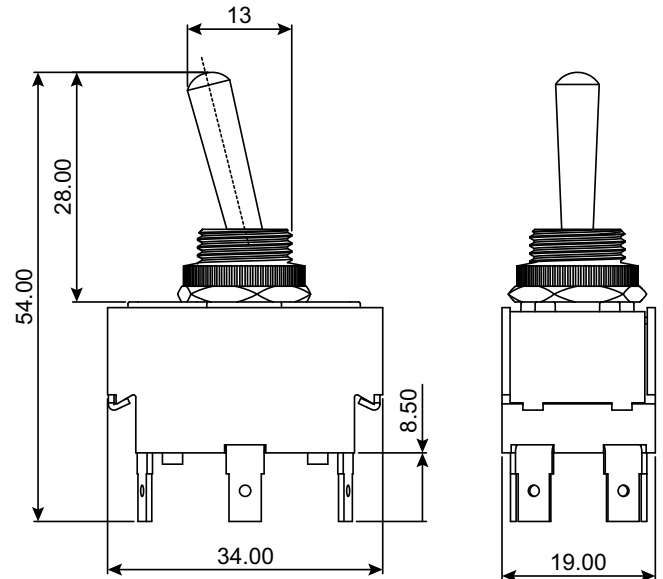
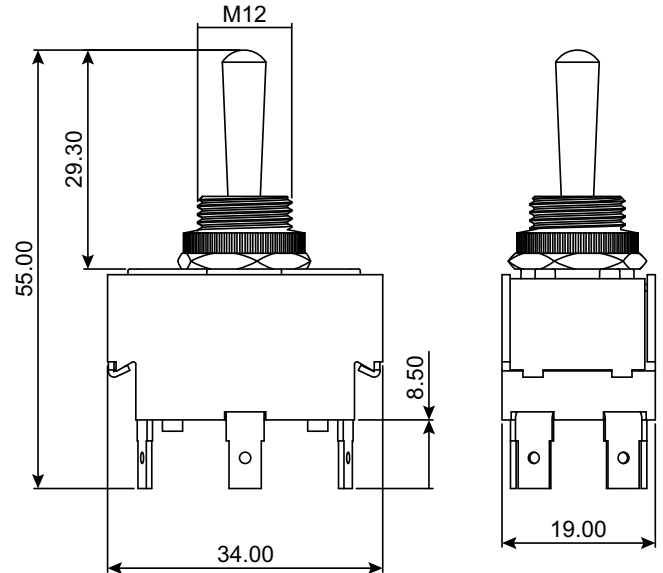

Economy Grade

BT6-S-DPDT-ON/ON-C
BT10-S-DPDT-ON/ON-C
BT16-S-DPDT-ON/ON-C

Industrial Grade

BT6-S-DPDT-ON/ON-P
BT10-S-DPDT-ON/ON-P
BT16-S-DPDT-ON/ON-P

Economy Grade

BT6-L-DPDT-ON/ON-C
BT10-L-DPDT-ON/ON-C
BT16-L-DPDT-ON/ON-C

Industrial Grade

BT6-L-DPDT-ON/ON-P
BT10-L-DPDT-ON/ON-P
BT16-L-DPDT-ON/ON-P

Off/Works: 830/2, GIDC Estate, Makarpura, Vadodara- 390010

Office: +91 - 9227979802 / 4

Sales: +91-9227979801

Email: sales@vitalelectrocomp.com

Web: www.vitalelectrocomp.com

Note: Technical specifications are subject to change without prior notice

Copyright© 2024 by Vital Electrocomp. All Rights Reserved